

GENERAL INFORMATION

26TH DANISH INTERNATIONAL SWIM CUP

CONTACT INFORMATION

Phone: +45 30 20 61 15

E-mail: swimcup@esbjergsk.dk

Website: <http://www.swimcup.dk/>

ADRESSES, ACCOMMODATION

Boldesager Skole Cosmos, Nørrebrogade 100, 6700 Esbjerg.

Fourfeldtskolen Bohr, Ndr. Fovrfeldvej 1, 6710 Esbjerg V.

Spangsbjergskolen Cosmos, Skrænten 120, 6700 Esbjerg.

Vitaskolen Bohr, Vester Gjesingvej 28, 6715 Esbjerg N.

ADRESSES, POOLS

Svømmestadion Danmark (SD), Gl. Vardevej 60, 6700 Esbjerg.

UC Syddanmark (UC), Skolebakken 167, 6705 Esbjerg Ø.

ARRIVAL

Teams, who have ordered accommodation and meals, shall upon arrival in Esbjerg check in at the school where they are staying.

Teams, who haven't ordered accommodation and meals, shall at arrival check in at the Information Desk at SD.

MEALS

Breakfast and lunch will be served at UC for the youngest groups of swimmers with dinner at Badminton Centeret.

Breakfast, lunch, and dinner will be served at Badminton Centret for the oldest groups of swimmers. Badminton Center is located next to SD.

OFFICIALS

List of officials will be available at <http://www.swimcup.dk/>. Only officials occurring on the lists are needed.

If the used official has registered for 4 or more sessions, meals and accommodation will be free during the entire competition. If the used official has registered for 3 or fewer sessions, only meal for the session used will be provided. An official can be several people sharing the task. If the task is shared, meals are also shared.

If an official has not been used, no meals or accommodation will be provided. Extra leader package, single meals and accommodation will have to be ordered.

An official can be one or several people sharing the tasks. If the task is shared, meals and accommodation are also shared.

Meal cards for officials according to the guidelines above are handed out to each club together with the welcome package.

Check map and pool overview further down for official meting locations at both pools.



BUS SERVICE

There will be bus service from all schools to both pools with continuous operation at peak times and with 20-60 minutes between buses running the rest of the day.

All teams will receive timetables, and these will be posted at the schools and pools.

The buses will be marked with flags and the name of the competition.

The buses drive in a circle, so you cannot get on a wrong bus.

INFORMATION DESK AT SD

Deposit for keys to the lockers in the changing room - 100 DKK or 10 Euro.

It is also here you can pick up the printed start lists.

ACCOMMODATION

At four schools in Esbjerg City.

List of schools can be found at <http://www.swimcup.dk/>.

On Sunday, luggage can be kept at the Badminton Centre at SD until departure. Baggage may only be placed on the stand by the blue seats.

COMPETITION

Start lists

Can be picked up at the Information Desk at SD for both pools. No start lists will be available at UC.

Start lists will also be made available at <http://www.swimcup.dk/>.

Withdrawals

After May 25th no further withdrawals can be made to the preliminary sessions.

For finals no later than 30 minutes after publication of results.

Results and livetiming

Links will be posted at <http://www.swimcup.dk/>.

Opening show Friday

Will start at 17.15 at SD. We encourage you all to attend and be there in good time.

Please pick up team signs at the Information Desk and be ready for team presentation during the show.

Show respect at the pools

Don't take up more space than necessary, to have room for everyone.

Please clean up after yourselves after each session.

It's not allowed to bring camping chairs or similar into the pool area due to increased rules regarding fire safety. Please use the chairs and benches provided in the pool area instead.

Forgotten items won't be collected during the competition, only Sunday evening after the finals.

Hygiene

It is a requirement that ALL swimmers wash thoroughly and without swimwear before entering the pools.

Swimmers who do not meet this requirement will be excluded from further participation.

Swimming rules

World Aquatics's current rules and regulations at the time of the competition will be followed.

COACH LOUNGE

Available at both pools featuring refreshments of various kinds.

To reduce trash, no single use cups will be available at the lounges. Please bring your own, it is possible to buy a thermal cup at the Information Desk.



PARKING

Please note that some areas around SD has a time limit on parking. See the map further down.

Always check the signs when you park.

All areas around UC and the schools have free parking.

WATERPARK

The water park at SD is open to all participants on Friday and Saturday 18.00-20.00.

WELCOME PACKAGE

Upon arrival at the school the team will receive a welcome package.

The teams **MUST** immediately upon arrival at the school check that the welcome packs and content correspond to the ordered.

Welcome packages include among other admission for swimmers, leaders, and officials.

The meal card gives access to the pools, buses, and meals, if ordered.

Take care of the card, since new meal vouchers must be purchased if lost.



SD, AREA

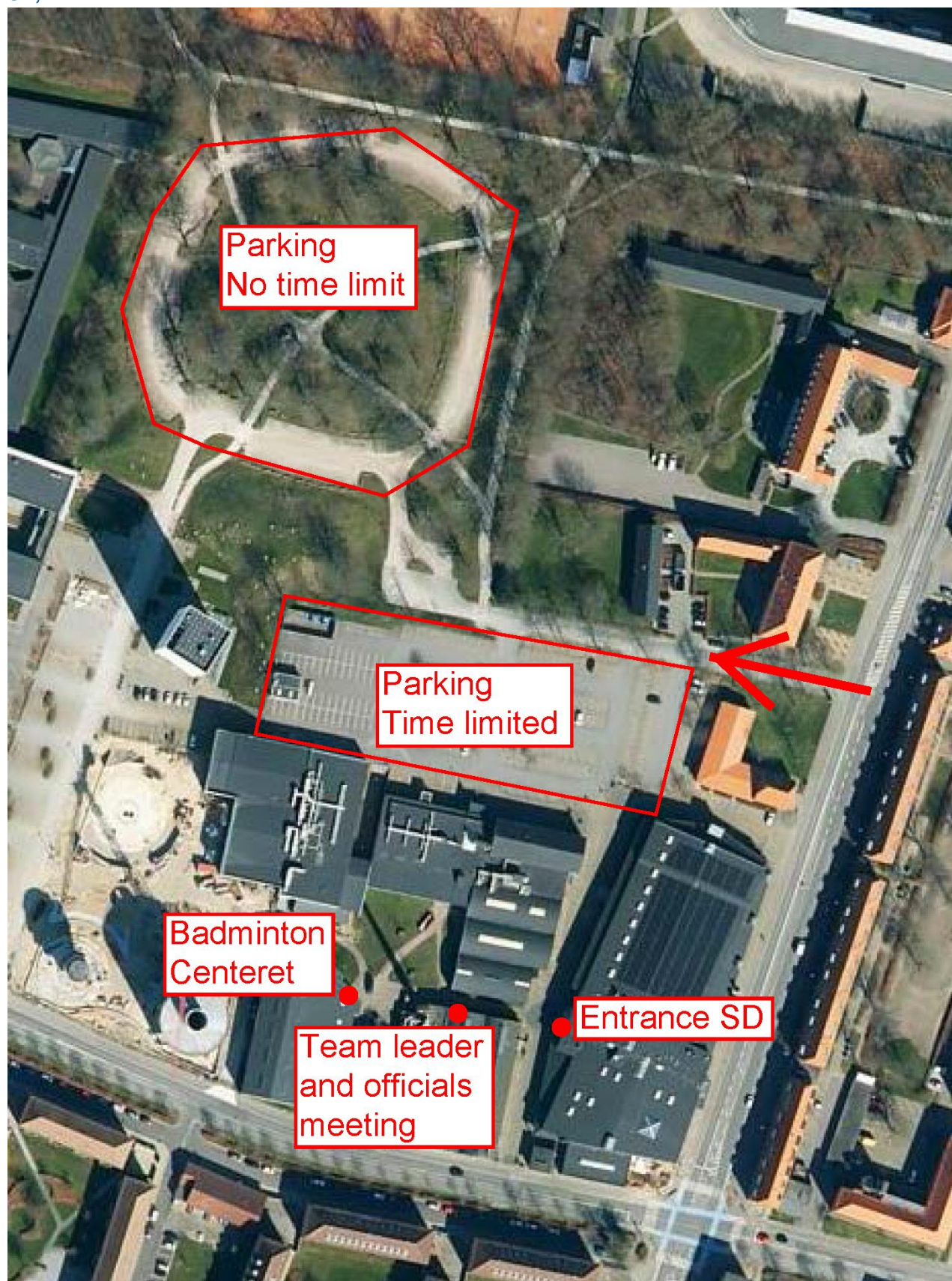

SD, POOL

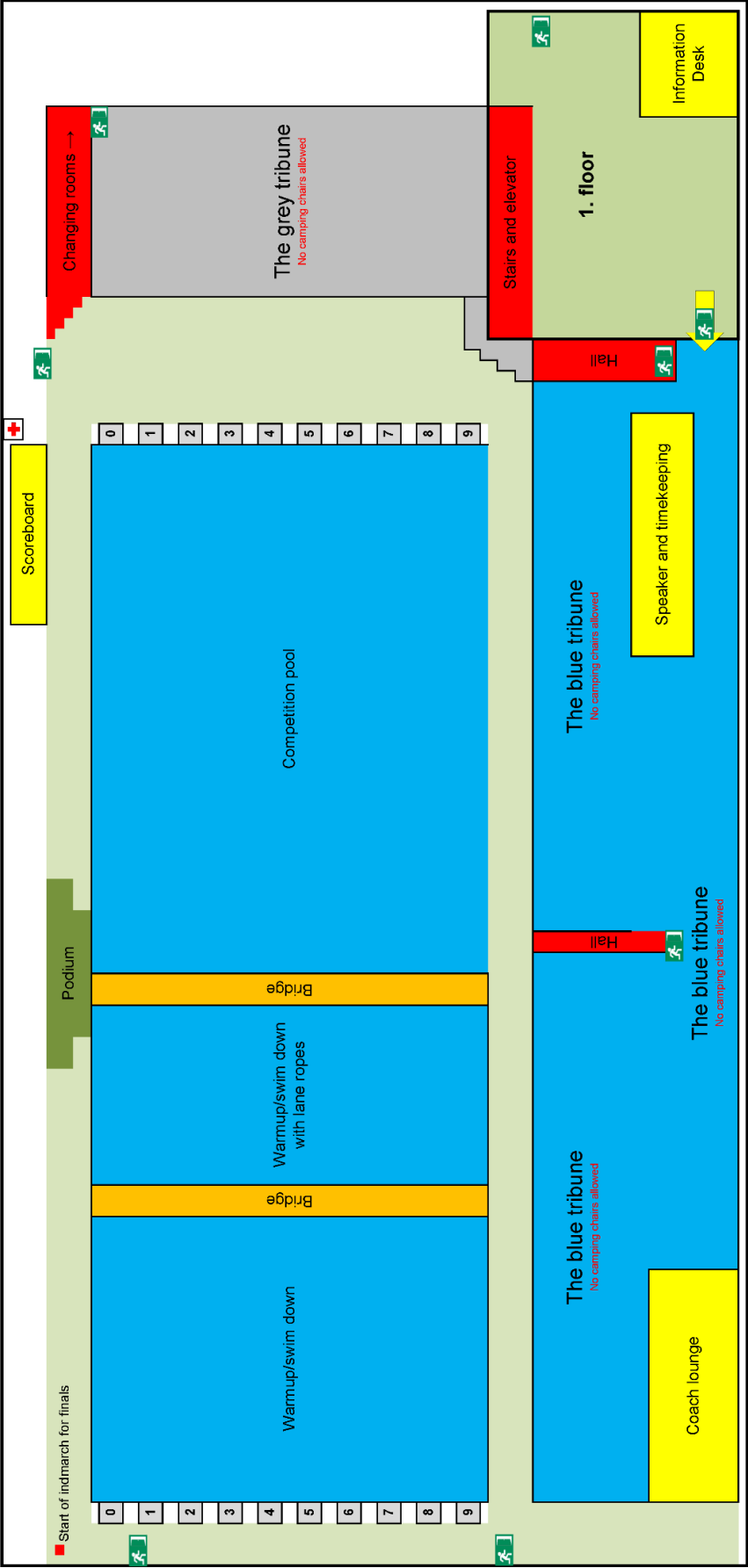

UC, BALCONY

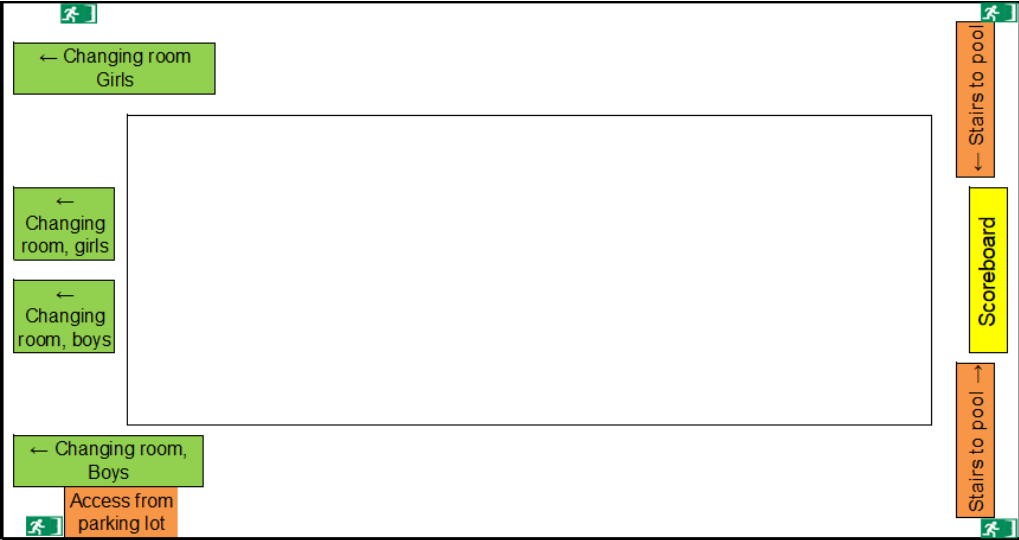

UC, POOL DECK

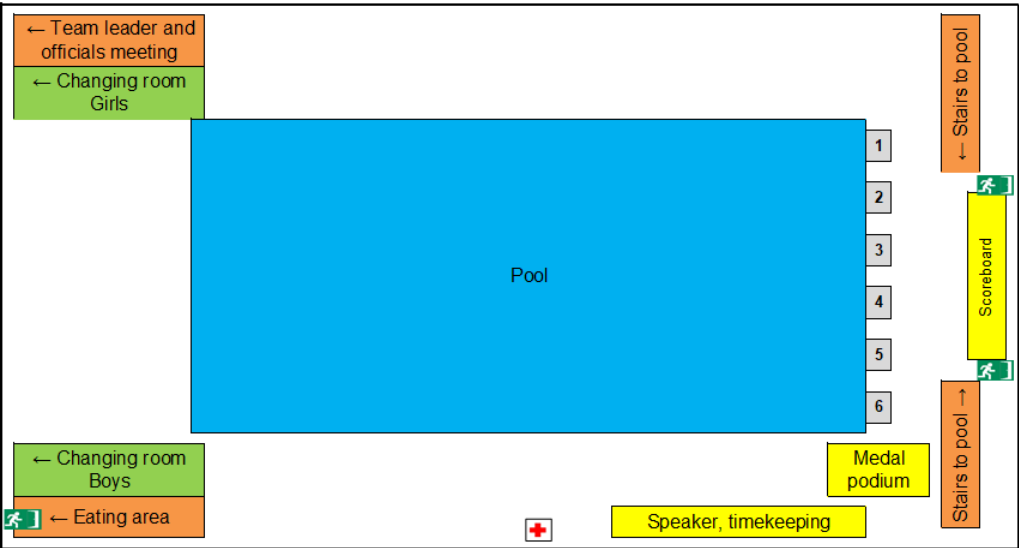

UC, DINING AREA

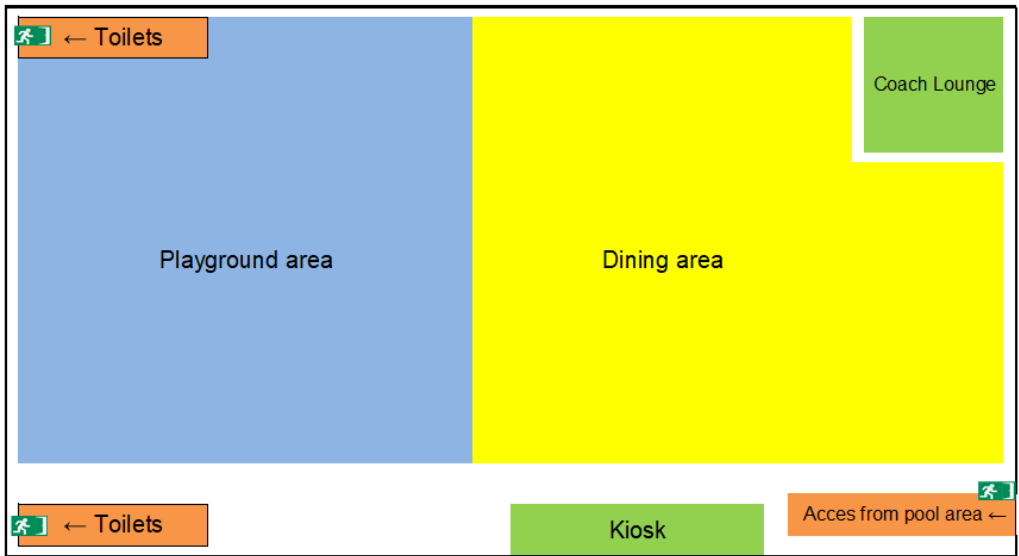

Time schedule	Thursday	Friday		Saturday		Sunday	
		Prelims	Finals	Prelims	Finals	Prelims	Finals
Access to pool	17.00	SD 6.30 UC 7.00	-	SD 6.30 UC 7.00	-	SD 6.30 UC 7.00	-
Warmup	17.00-18.30	7.00-8.20	16.20-17.20	7.00-8.20	16.00-17.00	7.00-8.20	14.45-15.45
Opening show			17.20		17.15		16.00
Competition start	-	8.30	18.15	8.30	17.30	8.30	16.15
Expected end of session	-	SD 14.00 UC 14.50	20.15	SD 15.10 UC 14.20	20.40	SD 14.15 UC 13.45	18.45
Swim down	-	SD 14.00-15.30 UC 14.50-15.20	20.15-20.35	SD 15.10-15.40 UC 14.20-14.50	20.40-21.10	SD 14.15-14.45 UC 13.45-14.15	18.45-19.05
Waterpark at SD			18.00-20.00		18.00-20.00		
Names for relays	-	-	-	.	15.30	.	.
Teamleader meeting	-	7.15	-	7.15	-	7.15	-
Officials meeting	-	7.30	16.15	7.30	16.30	7.30	15.00
Breakfast	-	6.00-8.00		6.00-8.00		6.00-8.00	
Lunch	-	11.00-13.30		11.00-13.30		11.00-13.30	
Dinner	-	18.00-21.00		17.30-21.00		-	
Bus	-	5.30-21.45		5.30-21.45		5.30-14.00	
Information Desk	16.00-19.00	7.00-15.50	16.20-20.15	7.00-15.25	16.45-21.10	7.00-19.05	
Arrival at schools	From 14.00	-	-	-	-	-	-
Departure from schools	-	-	-	-	-	-	10.00

